

## PORTABLE OXYGEN CONCENTRATOR

Product Code : MKPOC01

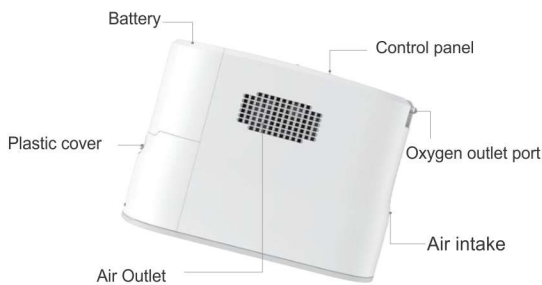
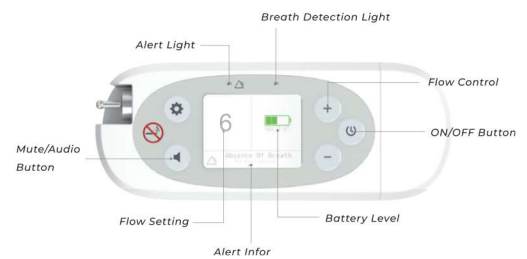

### Battery Duration

|                  |                |
|------------------|----------------|
| Setting flow     | 1 : 5 h 24 min |
|                  | 2 : 4 h 48 min |
|                  | 3 : 3 h 18 min |
| Battery duration | 4 : 2 h 30 min |
|                  | 5 : 2 h 06 min |
|                  | 6 : 1 h 42 min |

### Powerful Compressor



## Specifications :

|                      |   |
|----------------------|---|
| Oxygen Concentration | 90%-3%/+6% at all settings  |
| Oxygen Flow Max      | 1.2 Liter/min   |
| Warm-Up Time         | 2 minutes   |
| Weight               | 4.37 lbs. 1.98kg (includes battery)   |
| Size                 | Length: 8.70" (221mm)<br>Width: 6.30" (160mm)<br>Height: 3.35" (85mm) (includes battery)  |
| Oxygen Flow          | Pulse dose delivery system Five flow settings 1, 2, 3, 4, 5, 6  |
| Power                | Battery: Voltage: 14.4VDC<br>Rated capacity: 6.7Ah<br>AC Input: 100to240VAC 50 to 60 Hz<br>DC Input: 11-16VDC DC Output: 19V 6.3A<br>Duration : Up to 5.4 hours |
| Battery              | Recharge approximately 4 hours with AC or DC power  |
| Noise Level          | 49 Decibels* @setting 2   |
| Display Screen       | 2.8 inch  |
| Warranty             | 3years for main unit ,1 year for Sieve Bed and Battery  |
| Operation            | Simple control functions and easy-to-read LCD display   |
| Use                  | Designed for 24/7 use   |



High Efficiency



Excellent Heat Dissipation



Low Noise



Long Life

